

Material: Steel
Profiles: W20 (solid hot rolled steel profiles)
Single / Double glazing (up to 21mm)
Choice of different glazing beads
Fixed windows, Inward & Outward Opening Windows and Doors

Material: Steel

Profiles: W20 (solid hot rolled steel profiles)

Single / Double glazing (up to 21mm)

Choice of different glazing beads

Fixed windows, Inward & Outward Opening Windows and Doors

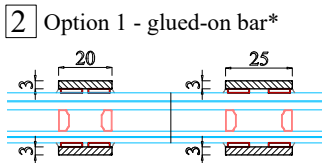
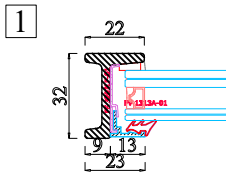
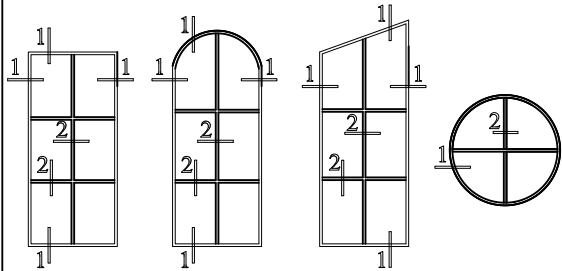

* other sizes upon request

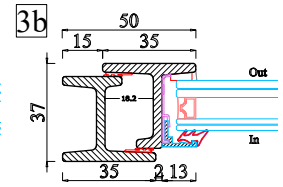
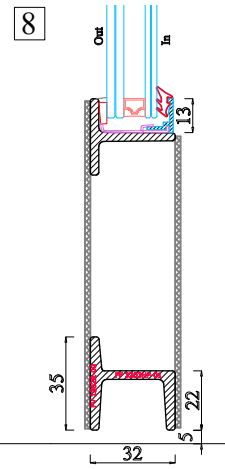
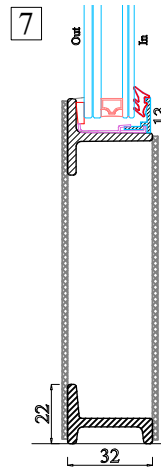
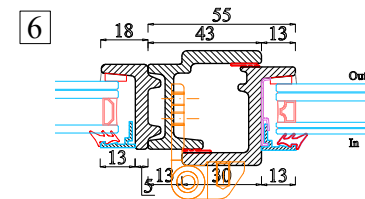
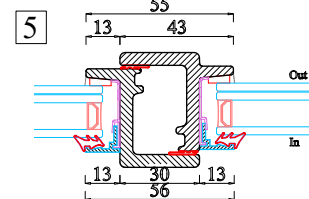
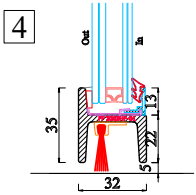
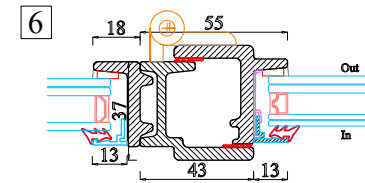
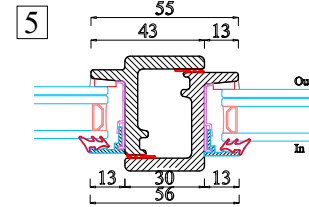
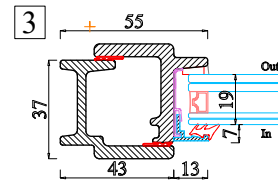
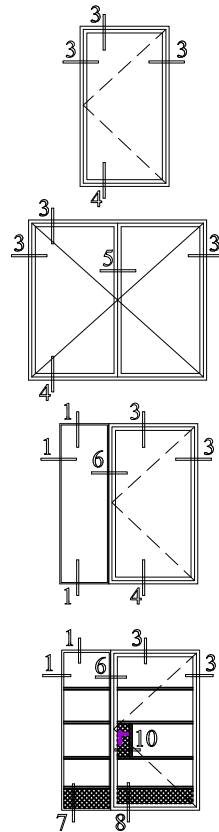
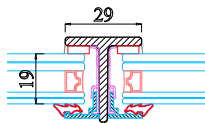
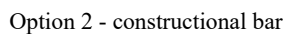

3a

Diagram 3a shows a cross-section of a channel section. The dimensions are: top flange width 13, web width 55, bottom flange width 13, total height 37, inner width 42, and distance from inner web to outer edge of bottom flange 30. Flow arrows indicate 'In' from the bottom right and 'Out' from the top right. A red 'X' is marked on the bottom flange.

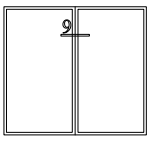
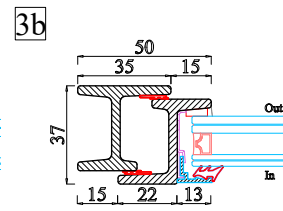

9 Two separate windows
that needs to be coupled on site**

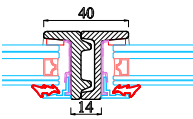

** if larger construction

Figure 1 consists of three schematic diagrams labeled A, B, and C, illustrating different microfluidic device designs. Each diagram shows a cross-section of a device with a central channel and side channels. The top of each device is labeled with a width of 29, and the bottom of each device is labeled with a width of 13. Diagram A shows a single channel with a central outlet. Diagram B shows multiple channels with a central outlet. Diagram C shows multiple channels with a central outlet, but with a different internal structure, possibly representing a different material or configuration.

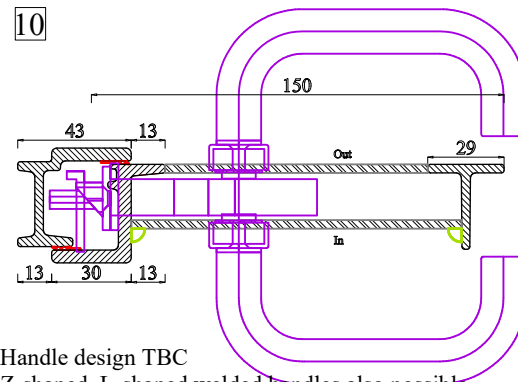
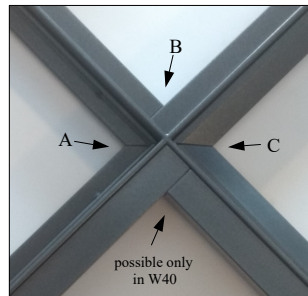

Handle design TBC

Z-shaped, L-shaped welded handles also possible